

SCARAB MINOR ROAD SWEEPER- Abbreviated Operating Instructions CANbus3

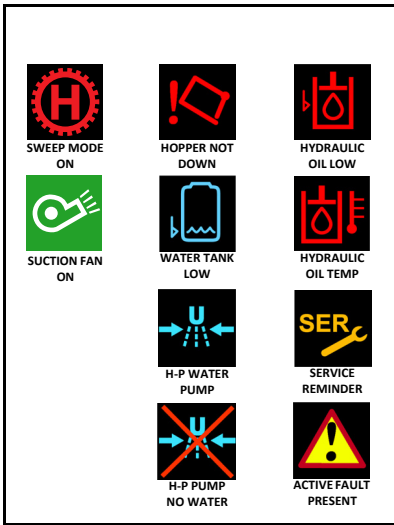
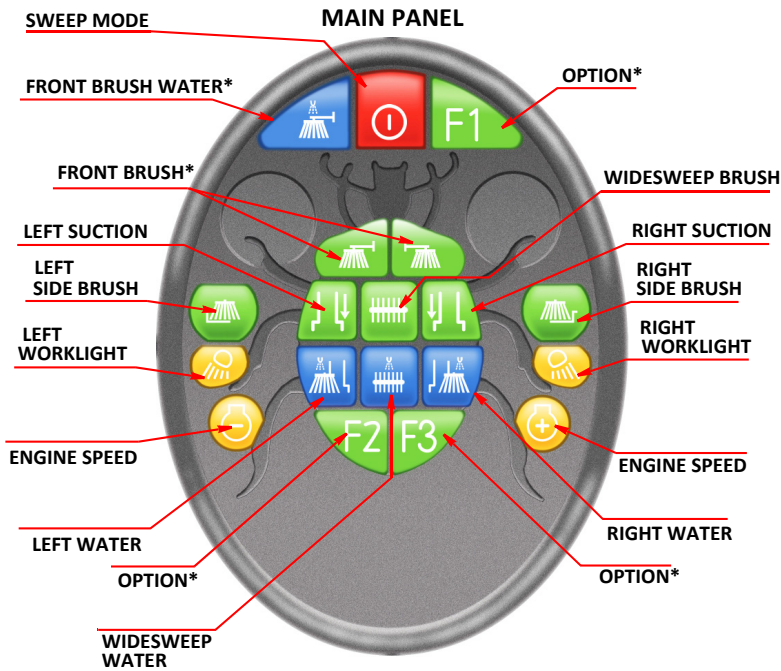

NORMAL DRIVE MODE

⚠ NO UNAUTHORISED OR UNTRAINED PERSONNEL TO OPERATE THIS SWEEPER.

- Select Neutral (Yellow Control Lever). Handbrake ON. Sweep Mode switch OFF. (L1) OFF. Start Engine.
- Select ECO mode if required, (restricts engine to a Maximum of 2000rpm).
- Select Forward or Reverse (Yellow Control Lever).
- Release handbrake, press accelerator pedal to move the vehicle.

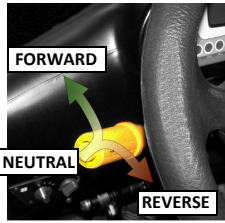

SWEEP MODE

- Stop vehicle. Handbrake ON.
- Sweep Mode switch ON. Engine RPM changes to pre-set level.
- Select the desired sweeping equipment. Switch on Suction Fan.

i Suction Fan speed (2000 RPM). Use Engine speed controls to change RPM if required.

- (L1) ON, beacons ON.
- Select FORWARD (Yellow Control Lever). Handbrake OFF, depress accelerator pedal to move vehicle.

i All sweeping equipment will stop and rise when REVERSE is selected, and re-engage in FORWARD.

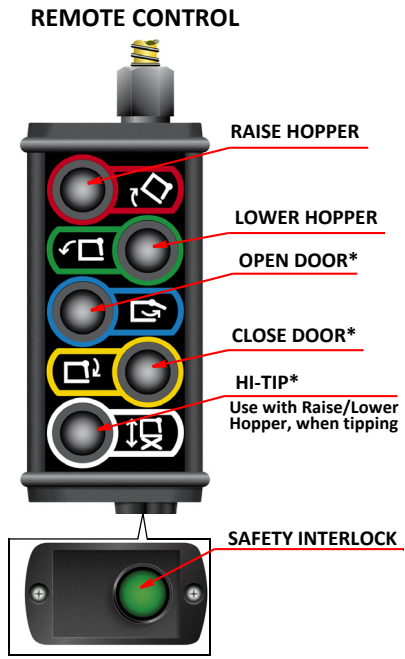
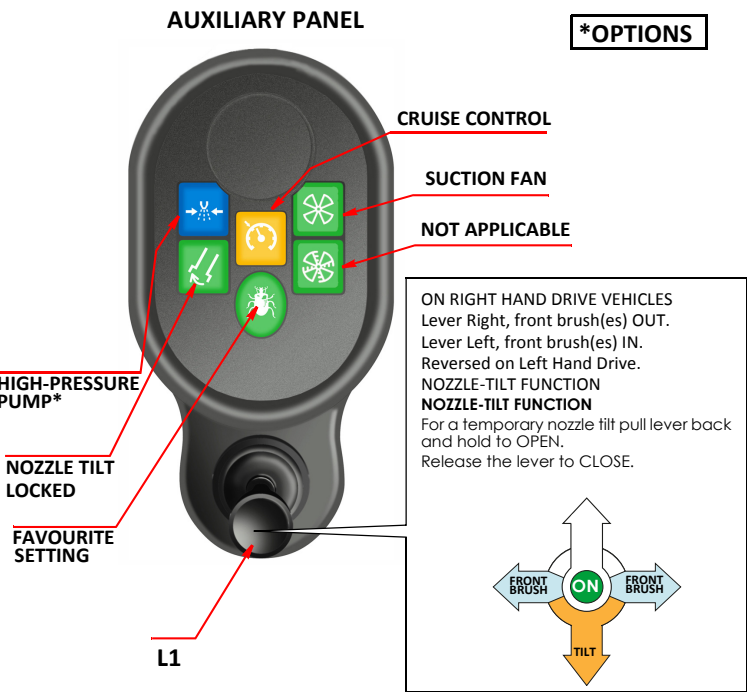

Press and hold down the Safety Interlock and the appropriate control switch.

For safety reasons only operate the Remote Control controls from outside the vehicle, from a vantage point that affords a good view of the sweeper and its surroundings.

CRUISE CONTROL (Only in Sweep Mode)

- With vehicle at the desired speed, select Cruise Control. Can be over-riden by the accelerator pedal, and is cancelled by using the foot brake or by pressing the switch.

i When sweeping with a full load or up-hill, engine RPM may need to be increased.

i Vehicle movement is controlled, by means of the accelerator and brake pedal, similar to a vehicle fitted with automatic transmission.

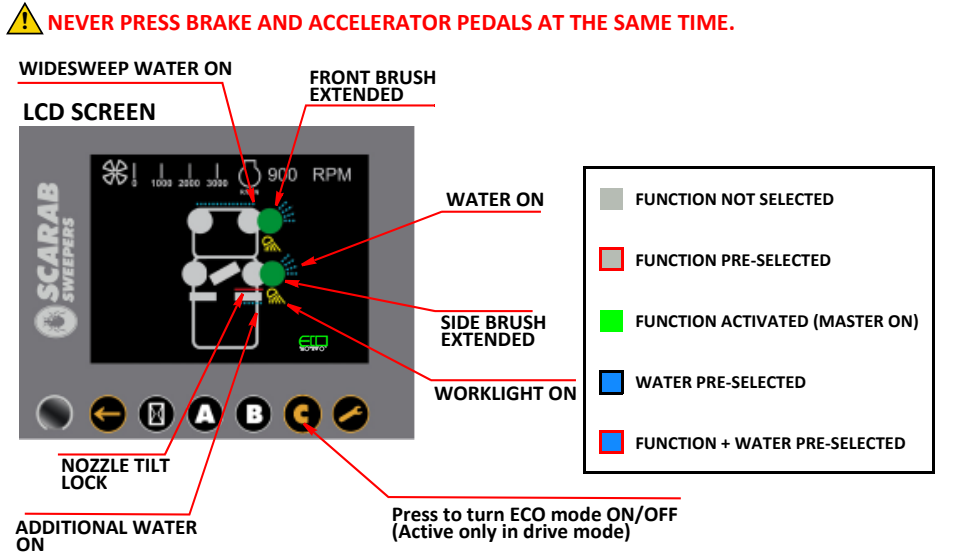

PLEASE REFER TO REVERSE FOR HEALTH & SAFETY ADVICE



- ONLY TRAINED OPERATIVES SHOULD BE ALLOWED TO DRIVE OR WORK ON THIS MACHINE.
- NEVER WORK UNDER A RAISED HOPPER, REAR DOOR OR CAB WITHOUT THE APPROPRIATE SAFETY PROP IN POSITION.
- DO NOT DRIVE THE VEHICLE WITH THE HOPPER RAISED. THE RED WARNING SYMBOL ON THE LCD MONITOR REMAINS ILLUMINATED UNTIL THE HOPPER IS FULLY DOWN.
- BEFORE WORKING ON THE VEHICLE ENSURE THAT IT IS ON FIRM, LEVEL GROUND, APPLY THE HAND BRAKE, STOP THE ENGINE AND REMOVE THE IGNITION KEY.
- BEFORE RAISING THE HOPPER OR OPENING THE REAR DOOR, ENSURE THAT THERE IS SUFFICIENT CLEARANCE AND IT IS SAFE TO DO SO.
- BEFORE STARTING THE ENGINE, ENSURE THAT ALL CONTROLS ARE SWITCHED OFF AND THE VEHICLE'S GEARBOX & HYDROSTATIC DRIVE ARE IN NEUTRAL.
- BEFORE DRIVING THE VEHICLE, ENSURE THAT ALL VEHICLE CHECKS HAVE BEEN CARRIED OUT AND THAT ALL EQUIPMENT IS STOWED AND THAT BRUSHES ARE RAISED.
- DO NOT OVERLOAD THE HOPPER.
- HIGH-PRESSURE WATER CAN BE DANGEROUS, ALWAYS WEAR SUITABLE EYE PROTECTION WHEN USING THE HAND-LANCE. DO NOT DIRECT THE WATER JET AT OTHER PERSONS.
- BEWARE OF ELECTRICAL FITTINGS ON PUBLIC BUILDINGS, LAMP POSTS ETC. MISUSE CAN RESULT IN SERIOUS INJURY.
- THE SUCTION FAN IS AN EXTREMELY HEAVY ROTATING MASS. VIBRATIONS EMANATING FROM THE SUCTION FAN MUST BE INVESTIGATED, THE CAUSE DETERMINED, AND RECTIFIED IMMEDIATELY.
- WHEN WORKING ON THE SUCTION FAN. NEVER ATTEMPT TO SLOW OR STOP THE FAN BY USING THE HANDS OR BY INSERTING ANY ITEM INTO THE FAN CHAMBER, EVEN AT LOW SPEEDS. FAILURE TO COMPLY CAN RESULT IN SERIOUS INJURY.
- WHEN OPERATING THE MACHINE IN ANY MODE ALWAYS BE AWARE OF OBJECTS AND PEOPLE IN THE IMMEDIATE VICINITY, ESPECIALLY AT THE REAR OF THE MACHINE WHEN REVERSING.
- WHATEVER THE SITUATION, REMEMBER THAT THE RULES OF TRAFFIC AND ROAD SAFETY MUST BE OBSERVED.
- WHILE OPERATING THIS MACHINE THE SAFETY AND WELL BEING OF OTHER PEOPLE ARE THE SOLE RESPONSIBILITY OF THE OPERATOR.

CAUTIONS



IF THE SUCTION FAN VIBRATES, IT SHOULD BE CLEANED IMMEDIATELY (REFER TO THE OPERATING INSTRUCTIONS). PROLONGED VIBRATION WILL RESULT IN DAMAGE TO THE FAN, BEARINGS AND, IN EXTREME CASES, THE HOPPER.
IN THE EVENT OF A HYDRAULIC OIL LEAK, STOP THE ENGINE AND INVESTIGATE.
THE HIGH AND LOW PRESSURE PUMPS MUST NEVER BE PERMITTED TO RUN DRY OR THE PISTON SEALS WILL BE DAMAGED.
DO NOT DIRECT THE HIGH-PRESSURE JET DIRECTLY AT PAINTWORK OR ELECTRICAL CONNECTIONS ON THE VEHICLE.

ROUTINE DAILY MAINTENANCE

1. CHECK VEHICLE'S GENERAL CONDITION (INC. TYRES, LIGHTS AND ALL FLUID LEVELS) IN ACCORDANCE WITH CHASSIS MANUFACTURERS' RECOMMENDATIONS.
2. CHECK HYDRAULIC OIL LEVEL. (NOTE: IF THE OIL LEVEL IS NOT MAINTAINED, THE SWEEPING PANEL WILL AUTOMATICALLY SHUT DOWN UNTIL THE OIL LEVEL IS CORRECT).
3. CHECK CONDITION OF BRUSHES AND REMOVE ANY ITEMS SUCH AS STRING THAT MAY BE ENTANGLED.
4. CHECK GROUND CLEARANCE OF SUCTION BOX RUBBER FLAPS SUCTION POWER CAN BE LOST IF CLEARANCES ARE INCORRECT BUT IT IS POSSIBLE TO SLIGHTLY VARY THESE SETTINGS TO BETTER SUIT SPECIFIC SWEEPING CONDITIONS ACCORDING TO OPERATOR'S EXPERIENCE.
5. CHECK WATER SPRAY JETS FOR BLOCKAGES.
6. CLEAN THE OIL COOLER AND CHECK THAT COOLING FAN FUNCTIONS (NOTE: IF FITTED, RED LIGHT AND BUZZER OPERATE WHEN MAX TEMPERATURE IS REACHED).
7. WASH THE VEHICLE, ENSURING THAT THE SUCTION FAN AND HOPPER SCREENS ARE CLEANED.
8. LUBRICATE BRUSH LINKS, PIVOT POINTS AND WIDE SWEEP BEARINGS.
9. REMOVE AND CLEAN THE WATER-STRAINER ELEMENTS.
10. ALWAYS LEAVE THE VEHICLE WITH THE REAR DOOR SLIGHTLY OPEN TO ALLOW WATER TO DRAIN OUT.
11. IN FROSTY WEATHER, DRAIN PUMPS & TANK, REMOVE WATER-STRAINER ELEMENTS, SWITCH ON ALL WATER SPRAYS AND RUN **LOW-PRESSURE** PUMP UNTIL DRY.



Hydraulic oil: HPL 32 or an equivalent.

Engine oil: 10w - 40

Coolant: Ethylene Glyco (Eskimo long life)

Brake fluid: DOT 4